

619 FROST AVENUE

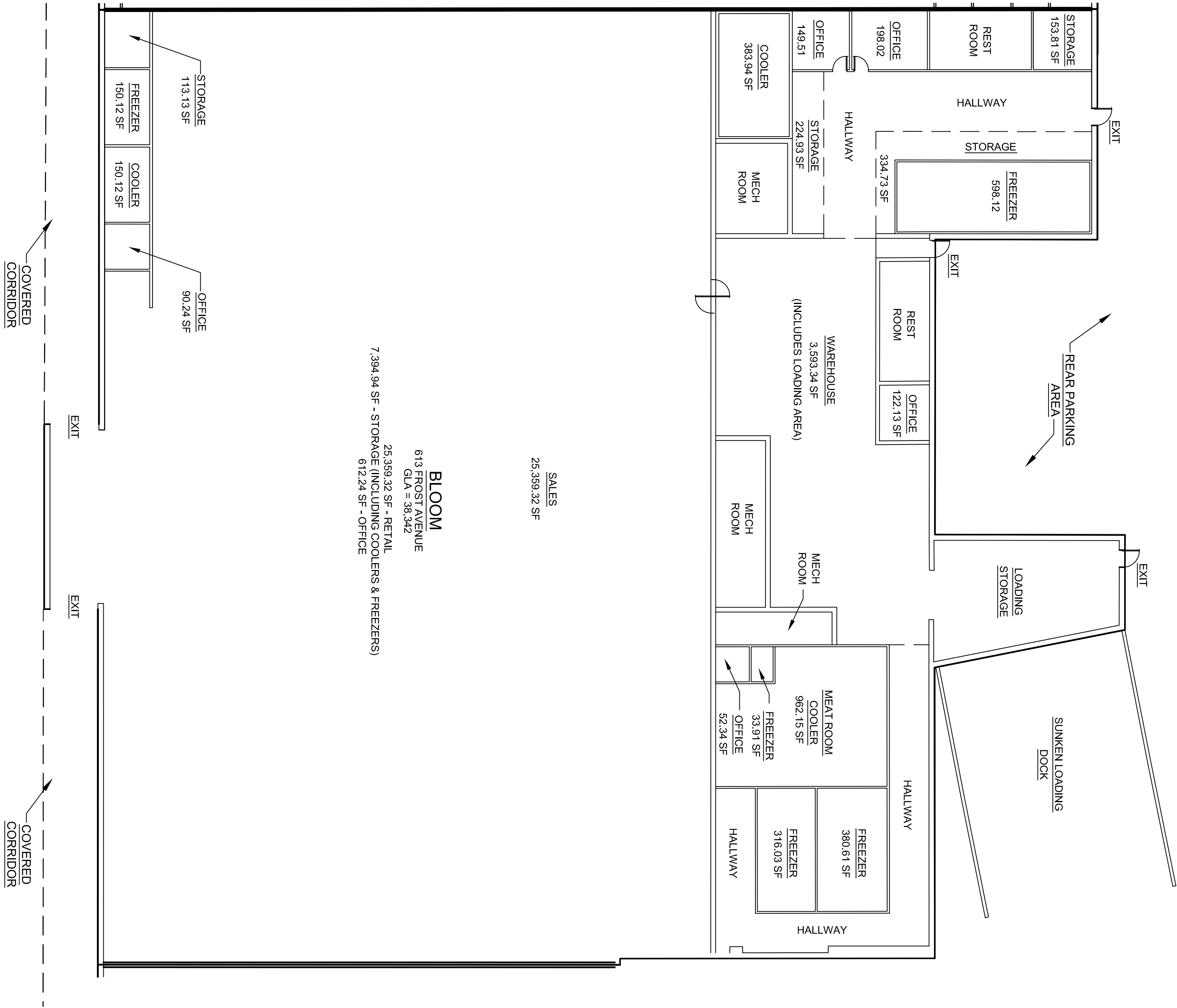

BLOOM
613 FROST AVENUE
GLA = 38,342
7,394.94 SF - STORAGE (INCLUDES COOLERS & FREEZERS)
612.24 SF - OFFICE
25,359.32 SF - RETAIL

SALES
25,359.32 SF

613 FROST AVENUE SQUARE FOOTAGE
TOTAL GROSS LEASEABLE AREA = 38,342 SF

EXISTING FLOOR PLAN
SCALE: 1/16" = 1'-0"



613 FROST AVENUE
(BLOOM)
WARRENTON TOWN CENTRE
TOWN OF WARRENTON
FAUQUIER COUNTY, VIRGINIA



REVISIONS



5 Rock Pointe Lane - Suite 200
Warrenton, Virginia 20186
540-349-8385
540-349-9588 fax
www.drhdesigngroup.com

CHECKED BY	DRH
DRAWN BY	SKG
SCALE	AS NOTED
DATE	02/21/08
FNA JOB NO.	207139
DRAWING NO.	A-01
SHEET	1 OF 1